

Self Clinching Quick Release Standoff Installation Guide

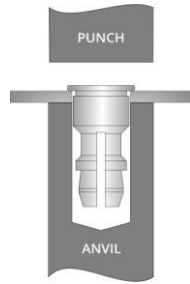

Punch Or Drill The Correct Hole Size
Place The Fastener In The Prepared Hole And Locate The Panel In The Anvil

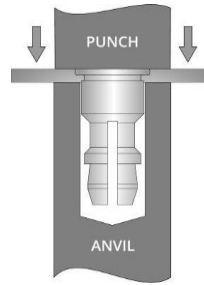

With The Panel Held Level
Apply A Parallel Squeezing Force
Until The Head Is Installed Flush To The Panel Surface.
Do Not Over Squeeze This Could Result In Panel Deformation.

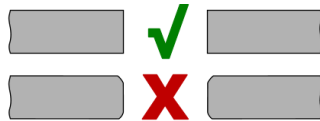
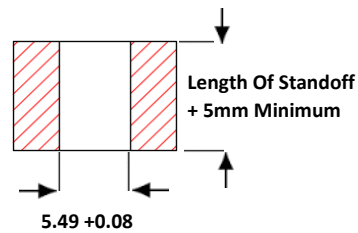
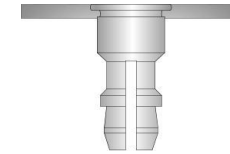

Do Not Remove Any Extra Material
OR Chamfer The Hole
This Could Result In Improper Installation
Or Reduced Performance

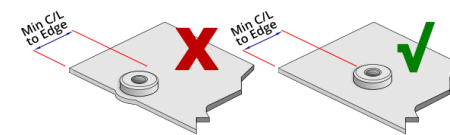

Ensure Attention Is Paid To The Minimum Hole Centreline To Edge Dimension For Each Fastener. Installing Too Close To An Edge Or Bend Could Result In Improper Installation Or Reduced Performance. Minimum Centreline To Edge Dimension For Each Fastener Apply To On Edge Only. If This Distance Is Applied On Multiple Sides There Will Be Significant Panel Distortion Unless The Panel Edges Are Supported During Installation.